

Part of District No 3

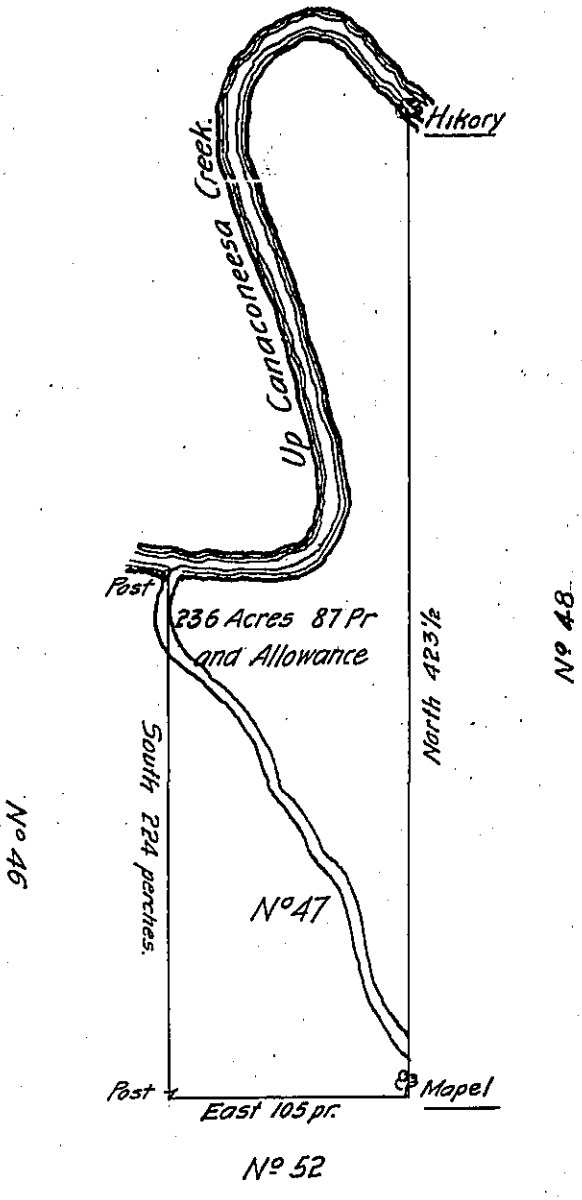

Courses down the Creek

N 36° W. 35 Perches
N 69 W. 14 P ^s
West 8 P.
S 46° W. 31 P.
S 33 W. 18 P.
S 5 E. 36 P.
S 25 E. 46 P.
S 16 E. 92
S 20 W. 24
S 56 W. 14
S 81 W. 16
N 86 W. 44
378

In pursuance of an Act of Assembly passed the 12th day of March 1783 for the sale of certain lands therein mentioned and by virtue of a Commission under the hand and seal of Office of John Lukens Esq^r Surveyor Generall for the State of Pennsylvania to me directed bearing date at Philad^a the 14th day of August 1783 the above tract of land containing two hundred and thirty six acres and Eighty seven perches with allowance of six per Cent for roads &c^a was surveyed the 15th of June 1785 by

Sam^l Nicholson

To John Lukens Esq^r
Surveyor General

IN TESTIMONY that the above is a copy of the original remaining on file in the Department of Internal Affairs of Pennsylvania, made conformably to an Act of Assembly approved the 16th day of February, 1833, I have hereunto set my Hand and caused the Seal of said Department to be affixed at Harrisburg, this twenty third day of November 1903.

James B. Brown
Secretary of Internal Affairs.